

**READ THESE INSTRUCTIONS THOROUGHLY BEFORE INSTALLATION KEEP THESE INSTRUCTIONS FOR FUTURE REFERENCE.**

**IMPORTANT:**

This product must be installed by a qualified electrician or competent person, and in accordance with current building and IET wiring regulations.

**BOX CONTENTS**

This lighting fixture has been properly packed to avoid damage during transit. Before commencing with the installation carefully inspect the luminaire to confirm there is no damage. **DO NOT INSTALL** if any damage has occurred to the fixture or any of its components.

- Light Fitting
- Instruction Manual

**TOOLS REQUIRED**

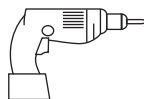

- Drill



- 100W requires 6mm Hex Key
- 150W - 280W requires 8mm Hex key



- Cable

**INSTALLATION INSTRUCTIONS**

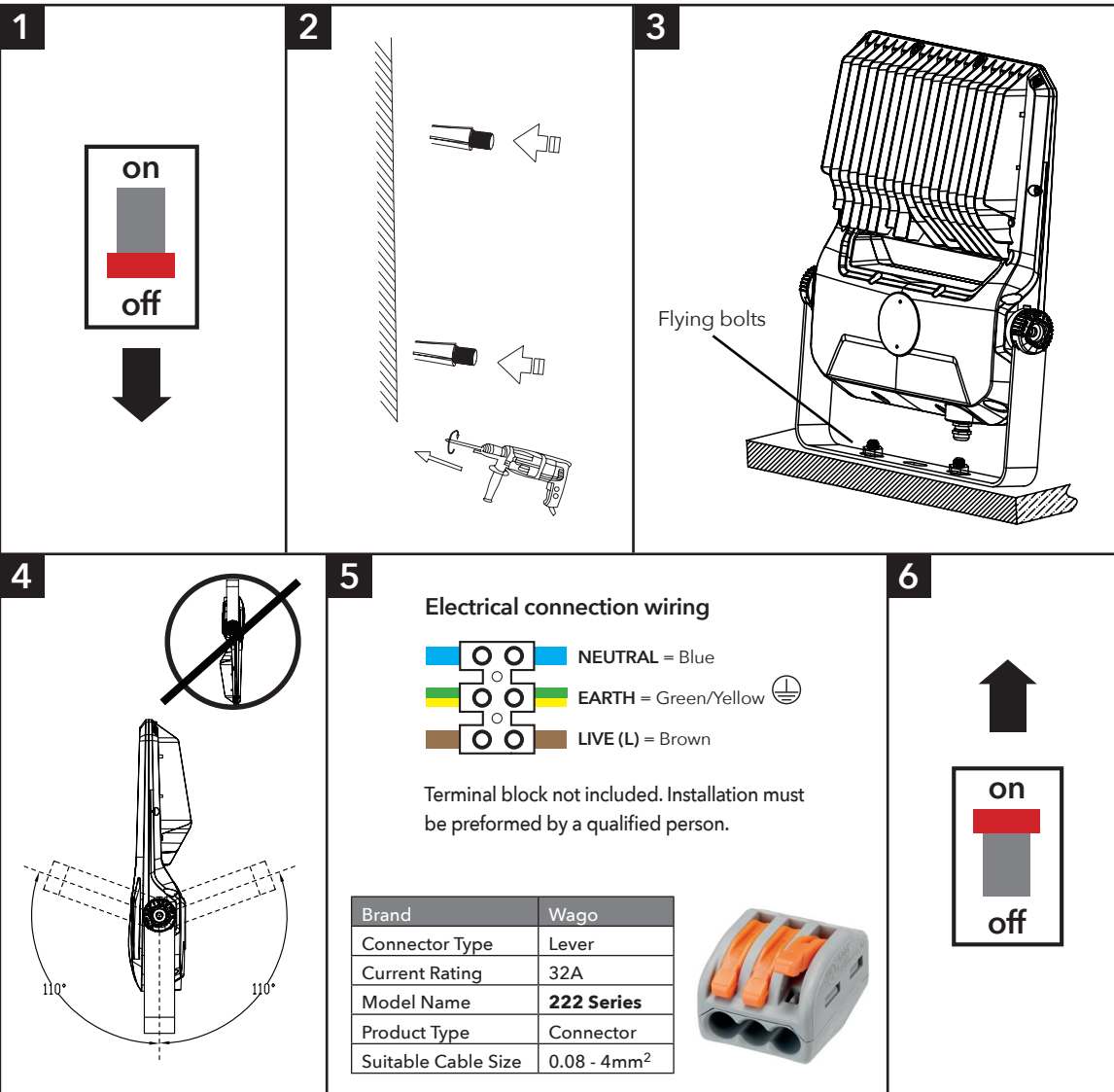

**PLEASE READ THESE INSTRUCTIONS BEFORE INSTALLATION.**



**WARNING: Risk of electric shock! Isolate the mains power before proceeding.**

- Turn off the mains power before performing inspections, installation, or removal
- Verify that the supply voltage is correct by comparing it with the luminaire label information
- It is the installers responsibility to ensure installation is suitable for the total load of the luminaire(s). The supply cable, fuses/circuit breakers must be correctly rated for the electrical load and considering for any transient inrush currents that may occur
- Do not perform insulation strength or resistance tests on installed luminaire(s) connected

1. Switch power off
2. Drill appropriately sized holes into your wall or ceiling and insert appropriate anchor bolts
3. Use correct fixings (see overleaf) for fixing the light to desired surface. If installing in an harsh environment, please use adequate corrosion resistant fixings
4. Adjust light fitting to correct angle. **DO NOT INSTALL UPSIDE DOWN**
5. Wire as per diagram (5)
6. Switch power back on

## DISPOSAL

Disassembly instructions for end of life disposal available on website.

Disposal of Electronic Equipment WEEE Directive 2002/96/EC This product falls within the scope of the Waste Electrical & Electronic Equipment Directive (WEEE), which means the product should not be disposed of as normal household waste. Please recycle where facilities exist or check with your Local Authority. RoHS - All components and materials used in this product are RoHS 2002/95/EC compliant.

Specifications may change from time to time. The information contained in this leaflet is for guidance only and should not be considered as always accurate and should be treated as not representative.

## WARRANTY

**This luminaire is warranted for a period of 5 years from the date of purchase\*\*.** The warranty could be invalidated should the light fitting not be installed according to these instructions, outside the scope of the specification or the product has been altered or tampered with in any way. Please see website for terms and conditions.

## PRODUCT TEMP SPECIFICATION

Standard -30 to +50°C

Revision L1.0 - MAY 2023

## WILTON SPORTS LIGHT DIMENSIONS

Part No.	Description	Watts	L (mm)	W (mm)	H (mm)	Fixing Size	Weight
430711	Wilton Asymmetric Sports Light	100W	325	264	55	M10	2.68Kg
430712	Wilton Asymmetric Sports Light	150W	442	323	85	M12	4.72Kg
430715	Wilton Asymmetric Sports Light	240W	467	385	94	M12	5.06Kg
430716	Wilton Asymmetric Sports Light	280W	467	385	94	M12	7.54Kg

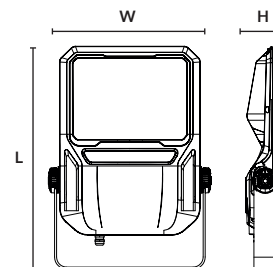

Installation Engineers Contact Details:

Name:

Tel:

Luminaire Reference / Location

This product contains a light source of energy efficiency Class B.

\*\* Please see our website for more detailed information on warranty.

Technical Helpline: +44 (0)1507 328031